

**Peak Force:** 180N\*\*/257N\*\*\*/308N  
**Max. Stroke:** 100/160/260/360  
 460/560/660/760  
 860/1060/1260  
 1460

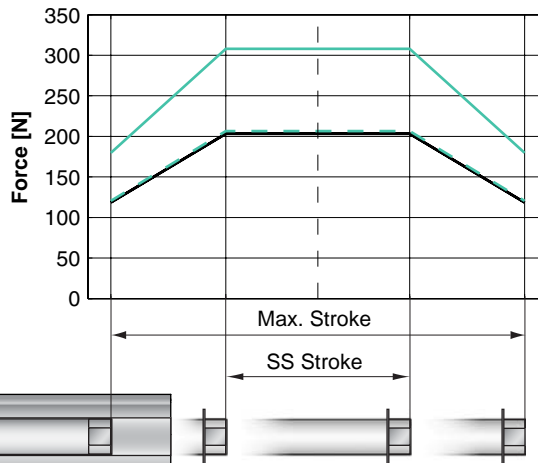

**Standard Winding:**  
 — E1100–HC, 72VDC  
 — E1100, 72VDC & E1001, 72VDC

**Fast Winding**  
 — E1100–HC, 72VDC  
 - - - E1100, 72VDC & E1001, 72VDC

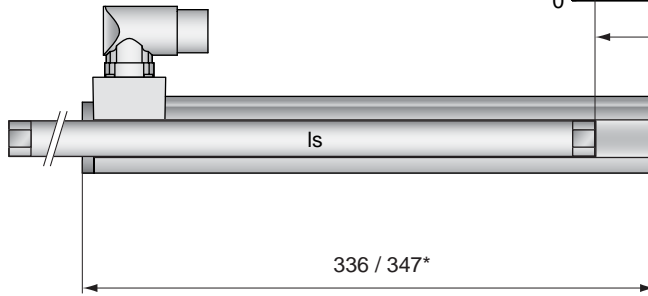

Dimensions in mm  
 \*Cable Type

## Motor Specification

	P01-	Connector Type						Cable Type					
		Standard Winding			Fast Winding			Standard Winding			Fast Winding		
		37x240-C			37x240F-C			37x240 37x240-C20			37x240F-C20		
Stroke Max.	mm (in)	100	160	260	360	460	560	660	760	860	1060	1260	1460
Stroke SS	mm (in)	100	40	60	160	260	360	460	560	660	860	1060	1260
Slider Diameter	mm (in)	20 (0.79)											
Slider Length	mm	305	635	395	500	600	700	800	900	1000	1200	1400	1600
Slider Mass	g	496	635	829	1064	1297	1529	1762	1994	2227	2692	3157	3622
Peak Force E1100-HC	N (lbf)	119(26.7)**/169(38.1)***/203(45.7)			180(40.4)**/257(57.7)***/308(69.2)			119(26.7)**/169(38.1)***/203(45.7)			180(40.4)**/257(57.7)***/308(69.2)		
Peak Force E1100/E1001	N (lbf)	119(26.7)**/169(38.1)***/203(45.7)			120(27.1)**/172(38.7)***/206(46.4)			119(26.7)**/169(38.1)***/203(45.7)			120(27.1)**/172(38.7)***/206(46.4)		
Cont. Force	N (lbf)	31**/44***/53 (7.0**/10***/12)											
Cont. Force Fan cooling	N (lbf)	58**/83***/100 (13.1**/18.7***/22.4)											
Border Force	%	100**/70***/58											
Force Constant	N/A (lbf/A)	23.8(5.35)**/34.0(7.64)***/40.8(9.17)			15.1(3.38)**/21.5(4.83)***/25.8(5.80)			23.8(5.35)**/34.0(7.64)***/40.8(9.17)			15.1(3.38)**/21.5(4.83)***/25.8(5.80)		
Max. Current @ 72VDC	A	5.0			11.9			5.0			11.9		
Max. Current @ 48VDC	A	3.3			8.0			3.3			8.0		
Max. Velocity @ 72VDC	m/s (in/s)	2.8(110)**/1.9(77)***/1.6(64)			4.4(173)**/3.1(121)***/2.6(101)			2.8(110)**/1.9(77)***/1.6(64)			4.4(173)**/3.1(121)***/2.6(101)		
Max. Velocity @ 48VDC	m/s (in/s)	1.9(73)**/1.3(51)***/1.1(43)			2.9(116)**/2.1(81)***/1.7(67)			1.9(73)**/1.3(51)***/1.1(43)			2.9(116)**/2.1(81)***/1.7(67)		
Phase Resist. 25/80 °C	Ohm	11.7/14.2			4.9/5.9			11.7/14.2			4.9/5.9		
Phase Inductance	mH	6.0			2.4			6.0			2.4		
Thermal Resistance	°K/W	2.3			2.2			2.3			2.2		
Thermal Time Const.	sec	3400			3200			3400			3200		
Stator Diameter	mm (in)	37 (1.46)											
Stator Length	mm (in)	336(13.23)						347(13.66)					
Stator Mass	g (lb)	1385 (3.05)											
Position Repeatability	mm (in)	±0.05 (±0.0020)											
Linearity	%	±0.20											
Position Rep. with ES	mm (in)	±0.01 (±0.0004)											
Linearity with ES	mm (in)	±0.01 (±0.0004)											

\*\* P01-37x240/100x100  
 \*\*\* P01-37x240/40x160

## Connector Type

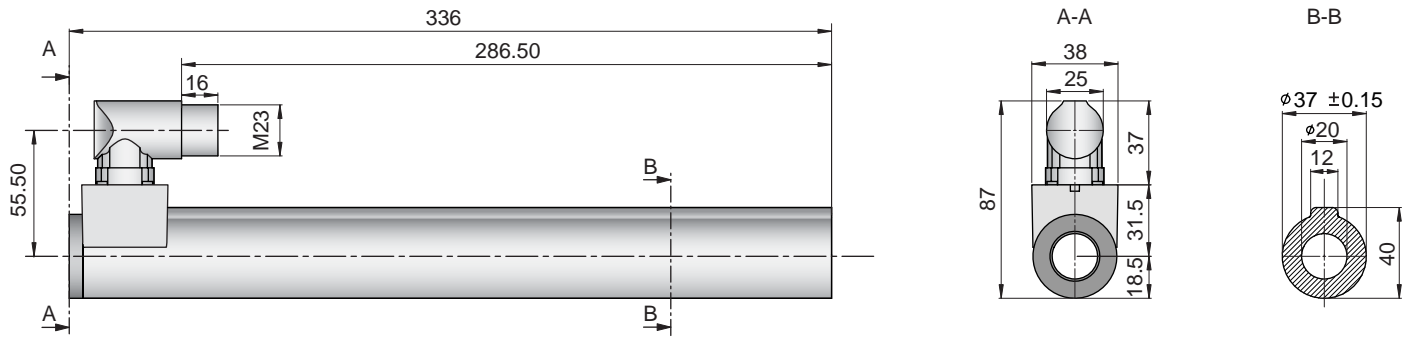

## Cable Type

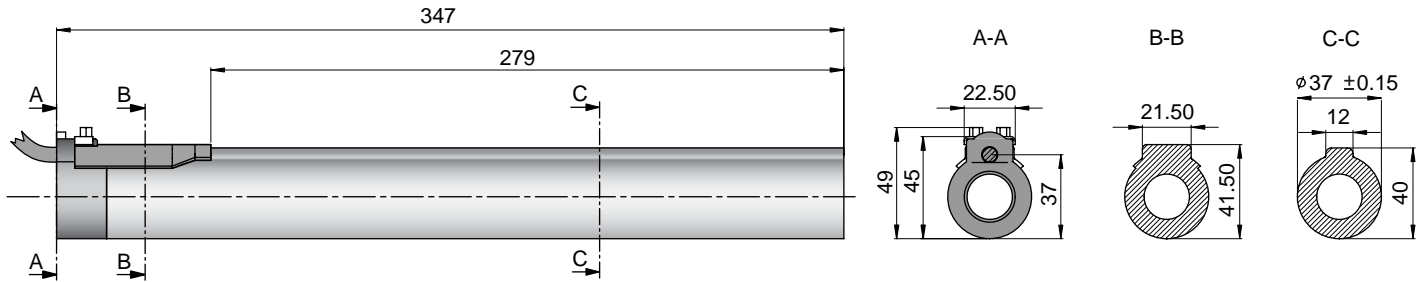

## PL01-20x.../...

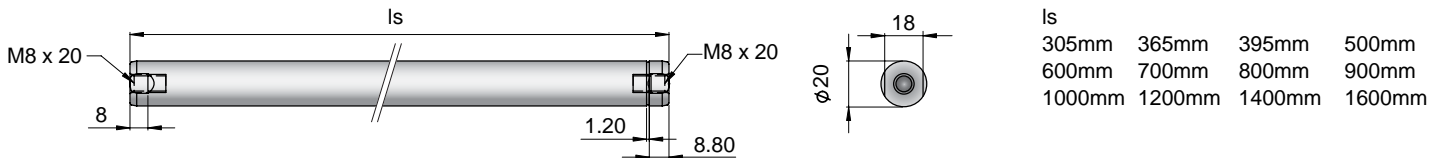

Linear Motor		Stator		Slider	
Type	Art.No	Type	Art. No.	Type	Art. No.
P01-37x240/100x100	-->			& PL01-20x305/160	0150-1311
P01-37x240/40x160	-->			& PL01-20x365/220	0150-1312
P01-37x240/60x260	-->			& PL01-20x395/320	0150-1318
P01-37x240/160x360	-->	PS01-37x240-C	0150-1224	& PL01-20x500/420	0150-1328
P01-37x240/260x460	-->	PS01-37x240F-C	0150-1225	& PL01-20x600/520	0150-1330
P01-37x240/360x560	-->	PS01-37x240	0150-1203	& PL01-20x700/620	0150-1332
P01-37x240/460x660	-->	PS01-37x240-C20	0150-1238	& PL01-20x800/720	0150-1334
P01-37x240/560x760	-->	PS01-37x240F-C20	0150-1239	& PL01-20x900/820	0150-1336
P01-37x240/660x860	-->			& PL01-20x1000/920	0150-1338
P01-37x240/860x1060	-->			& PL01-20x1200/1120	0150-1340
P01-37x240/1060x1260	-->			& PL01-20x1400/1320	0150-1342
P01-37x240/1260x1460	-->			& PL01-20x1600/1520	0150-1344

## Connectors

### Motor Connector Wiring

#### Cable Length:

P01-37x240...	1.5m
P01-37x240...-C20	0.2m

		P01-37...-C	P01-37...-C20	P01-37...
Ph 1+	red	A		1
Ph 1-	pink	B		2
Ph 2+	blue	C		3
Ph 2-	grey	D		4
+5VDC	white	E		5
GND	inner Shield	F		6
Sine	yellow	G		7
Cosine	green	H		8
Temp.	black	L		9
Shield	outer Shield	Case		10

## Accessoires

